

ELEVATION

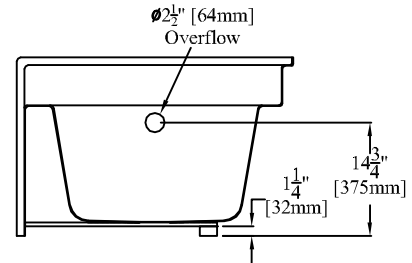

SECTION "A-A"

*** For clarity, ***
the whirlpool piping
has been omitted
from this drawing

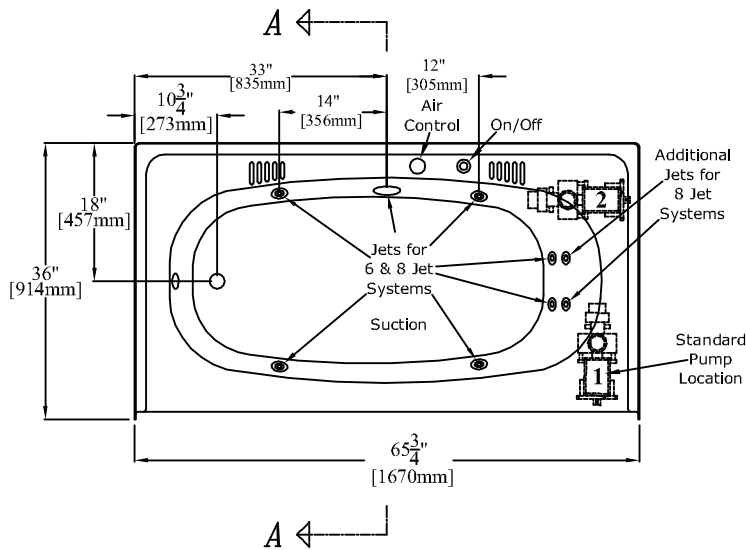

PLAN

*65 3/4" [1670mm] Bathtub
with 6 or 8 Jet Whirlpool Package*

Left Hand Version (RE6000L:6 or RE6000L:8) Shown

PRODUCT SPECIFICATIONS:

- * Product complies with NAHB, HUD UM-73A, and ANSI-Z124.1.
- * When installing this whirlpool, an access area should be provided near the location of the whirlpool pump for future access. An access area is required by many local, state & federal building codes.
- * Recommended access area dimensions: W-20" [508mm] H-15" [381mm]
- * Wood reinforced & slip resistant floor.
- * Integral 1" [25mm] nailing flange.
- * Factory drilled 2 1/2" [64mm] overflow.
- * Bathwell Dimensions (At Top): W-56 1/4" [1429mm] D-26 1/2" [673mm] H-15" [381mm]
- * Bathwell Dimensions (At Bottom): W-45 3/4" [1162mm] D-21 3/4" [552mm]
- * Bathwell Capacity (At Overflow): 48 Gallons [182L]
- * Water Level (At Overflow): 11 1/2" [292mm]
- * This unit is available without an overflow. (Model RE6000LM:6, RE6000LM:8, RE6000RM:6, or RE6000RM:8)
- * This unit is available with a removable access panel. (Model RE6000LA:6, RE6000LA:8, RE6000RA:6 or RE6000RA:8)
- * The pump location that is labeled 2 is an alternate pump location that is available.
- * All dimensions +/- 1/4" [6.4mm]
- * Clarion Bathware reserves the right to change design and/or dimensions.

Model RE6000L:6, RE6000L:8, RE6000R:6 or RE6000R:8

65 3/4" [1670mm] Bathtub with Left or Right Hand Drain & 6 or 8 Jet Whirlpool Package

Clarion
BATHWARE
44 Amsler Ave.
Shippenville, PA 16254

Phone: (814) 226-5374
Toll Free: (800) 576-9228
Fax: (814) 226-0730
www.clarionbathware.com

Signatures For Approval:

Customer: _____
Arch./Engr: _____
Contractor: _____
Cla. Engr: _____

Date:

Dwg. Name:
6000Lor6000R
-4&6JETCUT

Dwg. By: DJC
DATE: 4/1/10