

Clarion Bathware

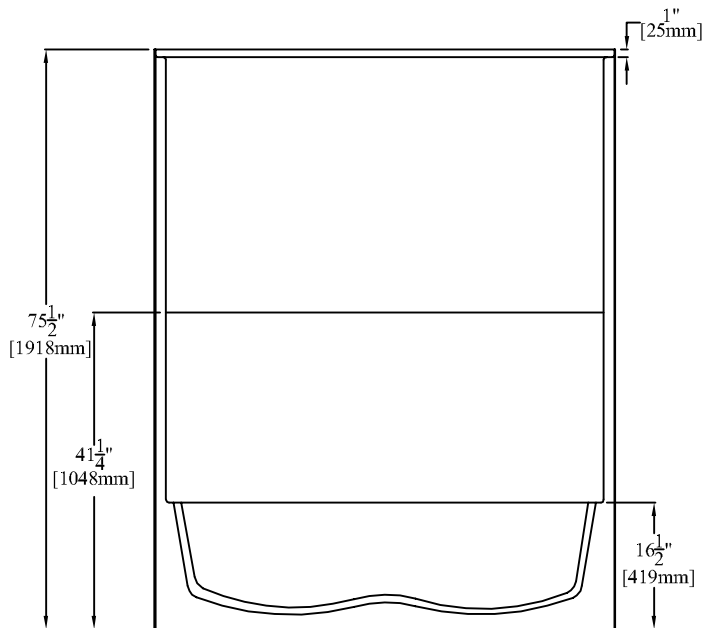

ELEVATION

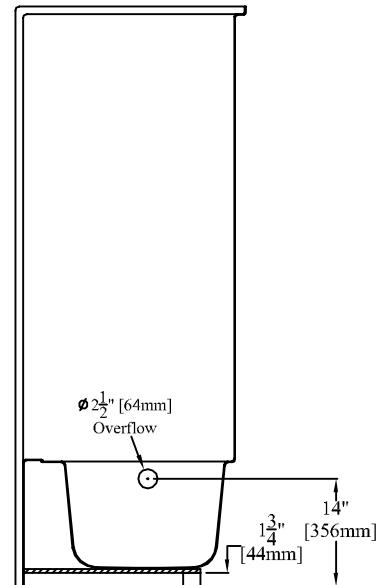

SECTION "A-A"

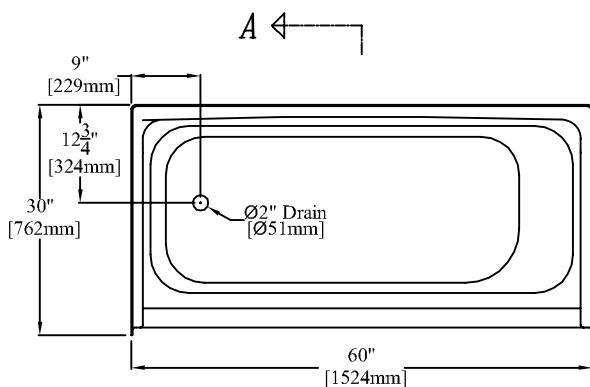

PLAN

60" [1524mm] 1-Piece Tub/Shower
with Left or Right Hand Drain

Left Hand Version (Model 7920L) Shown

PRODUCT SPECIFICATIONS:

- * Product complies with NAHB, HUD UM-73A, and ANSI-Z124.1.
- * Wood reinforced & slip resistant floor.
- * Integral 1" [25mm] nailing flange.
- * Factory drilled 2 1/2" [64mm] overflow.
- * Door Opening: W-56 7/8" [1445mm]
H-57 3/4" [1467mm]
- * Bathwell Dimensions (At Top): W-55" [1397mm]
D-21 1/2" [546mm]
H-14 1/4" [362mm]
- * Bathwell Dimensions (At Bottom): W-46" [1168mm]
D-19" [483mm]
- * Bathwell Capacity (At Overflow): 44 Gallons [167L]
- * Water Level (At Overflow): 10 1/4" [260mm]
- * Accepts Clarion Bathware Model 931 Cap. (Adds 9" [229mm] to the overall height of the unit)
- * All dimensions +/- 1/4" [6.4mm]
- * Clarion Bathware reserves the right to change design and/or dimensions.
- * Dimensions are the same for RE, RS, MP, CU and all other versions of this model.

Model 7920L or 7920R

60" [1524mm] 1-Piece Flat Wall Tub/Shower with Left or Right Hand Drain

Clarion
BATHWARE
44 Amsler Ave.
Shippenville, PA 16254

Phone: (814) 226-5374
Toll Free: (800) 576-9228
Fax: (814) 226-0730
www.clarionbathware.com

Signatures For Approval:

Customer: _____
Arch./Engr: _____
Contractor: _____
Cla. Engr: _____

Date:

Dwg. Name:
7920Lor7920R
-CUT

Dwg. By: DJC
DATE: 6/13/07