

Clarion Bathware

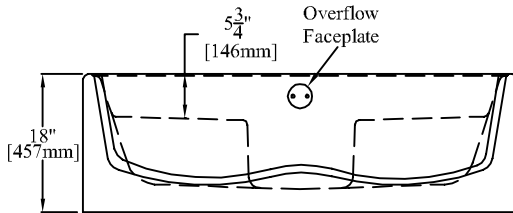

ELEVATION

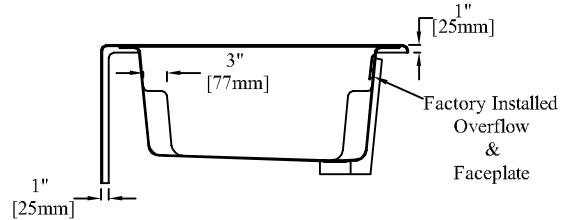

SECTION "A-A"

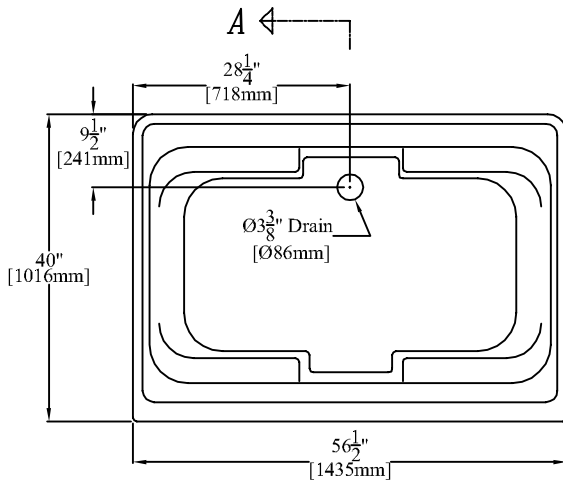

PLAN

Tub Insert for Model 6043SD Convertible Shower

PRODUCT SPECIFICATIONS:

- * Product complies with NAHB, HUD UM-73A, and ANSI-Z124.2.
- * This product is not a stand alone unit. It is a tub insert for a Clarion Bathware model 6043SD convertible shower stall. This tub insert allows the model 6043SD shower stall to be converted into a tub/shower.
- * Special installation instructions for this product must be followed carefully and the installation must be performed using the included installation kit.
- * Bathwell Dimensions (At Top): W-52 1/4" [13271mm]
D-30 3/4" [781mm]
H-14 3/4" [375mm]
- * Bathwell Dimensions (At Bottom): W-44" [1118mm]
D-19 3/4" [502mm]
- * Bathwell Capacity (At Overflow): 43 Gallons [163L]
- * Water Level (At Overflow): 10 1/2" [267mm]
- * Wood reinforced & slip resistant floor.
- * Overflow and overflow faceplate come factory installed.
- * All dimensions +/- 1/4" [6.4mm]
- * Clarion Bathware reserves the right to change design and/or dimensions.
- * Dimensions are the same for RE, RS, MP, CU and all other versions of this model.

Model 6043T

Tub Insert for Model 6043SD Convertible Shower

Clarion
BATHWARE
44 Amsler Ave.
Shippenville, PA 16254

Phone: (814) 226-5374
Toll Free: (800) 576-9228
Fax: (814) 226-0730
www.clarionbathware.com

Signatures For Approval:

Customer: _____
Arch./Engr: _____
Contractor: _____
Cla. Engr: _____

Date:

Dwg. Name:
6043T
-CUT

Dwg. By: DJC
DATE: 10/25/07