

Clarion Bathware

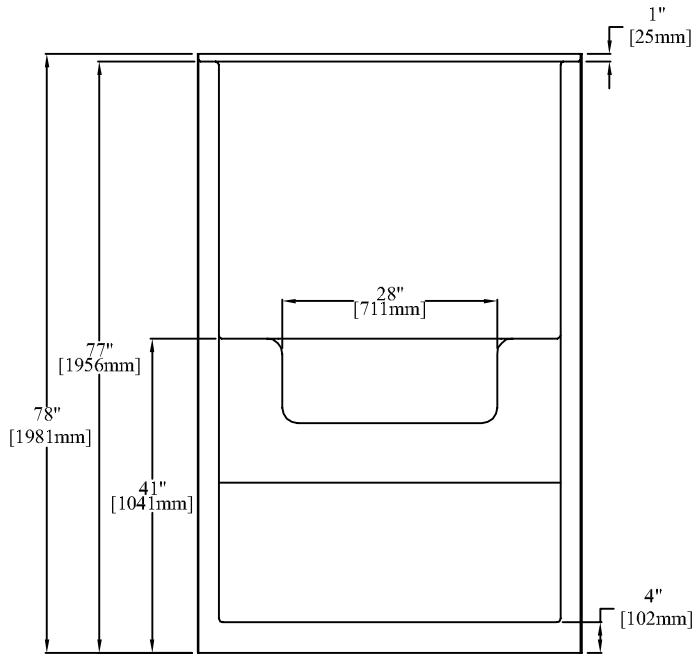

ELEVATION

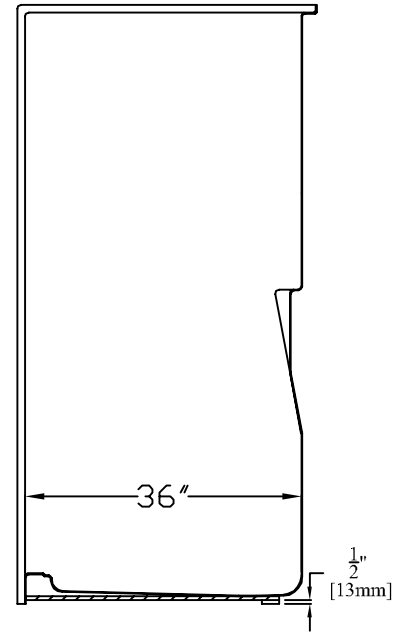

SECTION "A-A"

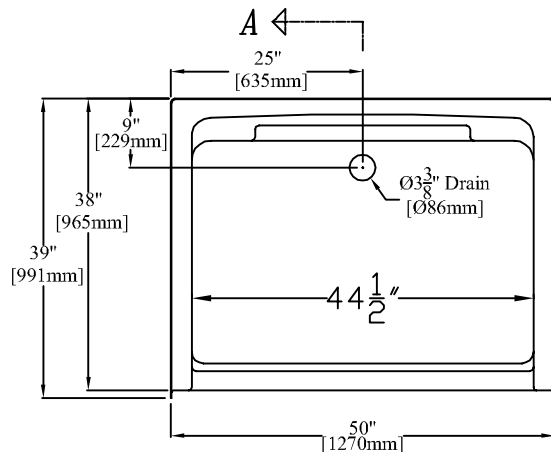

A ←

PLAN

50" [1270mm] Shower Stall with a Molded Soap Ledge

PRODUCT SPECIFICATIONS:

- * Product complies with NAHB, HUD UM-73A, and ANSI-Z124.1.
- * Wood reinforced & slip resistant floor.
- * Integral 1" [25mm] nailing flange.
- * Door Opening: W-44 1/2" [1130mm]
H-72 1/2" [1842mm]
- * Floor Space: W-44 1/2" [1130mm]
D-32 1/2" [826mm]
- * All dimensions +/- 1/4" [6.4mm]
- * Clarion Bathware reserves the right to change design and/or dimensions.
- * Dimensions are the same for RE, RS, MP, CU, and all other versions of this model.

Model 5039SD

50" [1270mm] Shower Stall with a Molded Soap Ledge

Clarion
BATHWARE
44 Amsler Ave.
Shippenville, PA 16254

Phone: (814) 226-5374
Toll Free: (800) 576-9228
Fax: (814) 226-0730
www.clarionbathware.com

Signatures For Approval:

Customer: _____
Arch./Engr: _____
Contractor: _____
Cla. Engr: _____

Date:

Dwg. Name:
5039SD-CUT

Dwg. By: DJC
DATE: 11/5/07