

Clarion Bathware

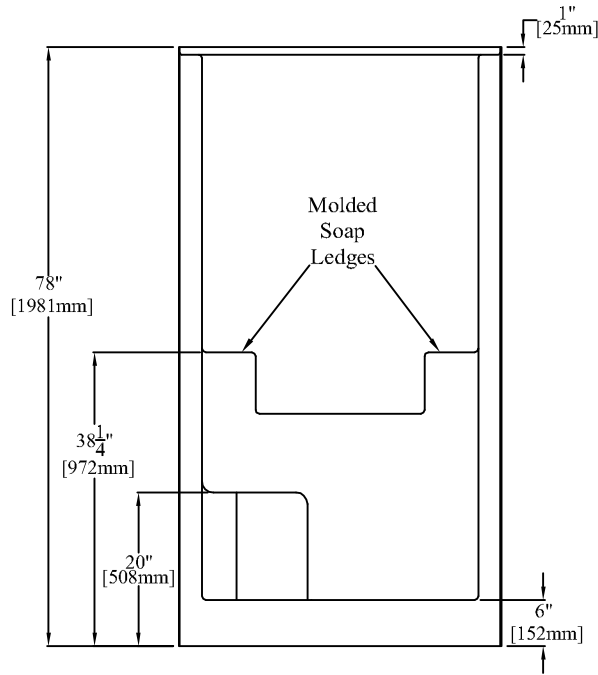

ELEVATION

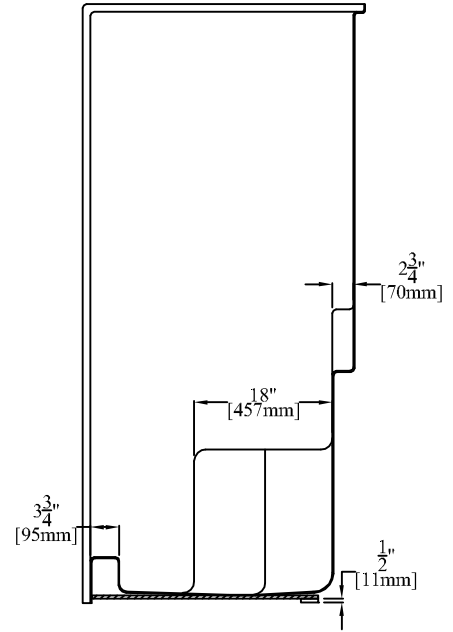

SECTION "A-A"

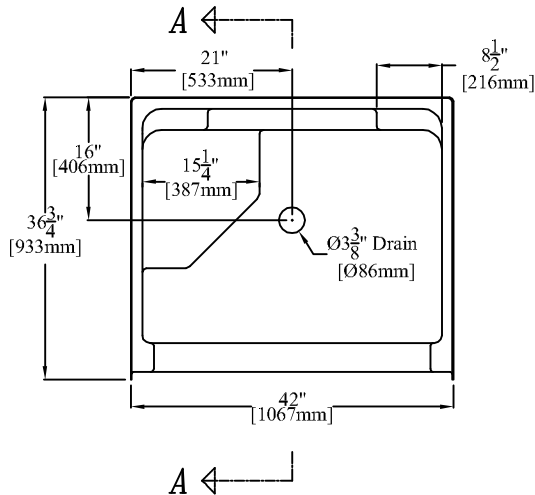

PLAN

42" [1067mm] 1-Piece Shower With
 6" [152mm] Threshold, Molded Soap Ledges
 & Molded Seat Located Opposite Valve Wall

Right Hand Version (4236R/S) Shown

PRODUCT SPECIFICATIONS:

- * Product complies with NAHB, HUD UM-73A, and ANSI-Z124.2.
- * Reinforced & slip resistant floor.
- * Integral 1" [25mm] nailing flange.
- * Molded soap ledges.
- * Molded seat located opposite the valve wall.
- * Door Opening: W-36" [914mm]
 H-70 3/4" [1797mm]
- * All dimensions +/- 1/4" [6.4mm]
- * Clarion Bathware reserves the right to change design and/or dimensions.
- * Dimensions are the same for RE, RS, MP, CU and all other versions of this model.

Model 4236L/S or 4236R/S

42" [1067mm] 1-Piece Shower with 6" [152mm] Threshold, Molded Soap Ledges & Molded Seat

Clarion
 BATHWARE
 44 Amsler Ave.
 Shippenville, PA 16254

Phone: (814) 226-5374
 Toll Free: (800) 576-9228
 Fax: (814) 226-0730
 www.clarionbathware.com

Signatures For Approval:

Customer: _____
 Arch./Engr: _____
 Contractor: _____
 Cla. Engr: _____

Date: _____

Dwg. Name:
 4236L.Sor4236RS
 -CUT

Dwg. By: DJC
 DATE: 10/27/08